

WIERTŁA

Wiertła nieprzelotowe

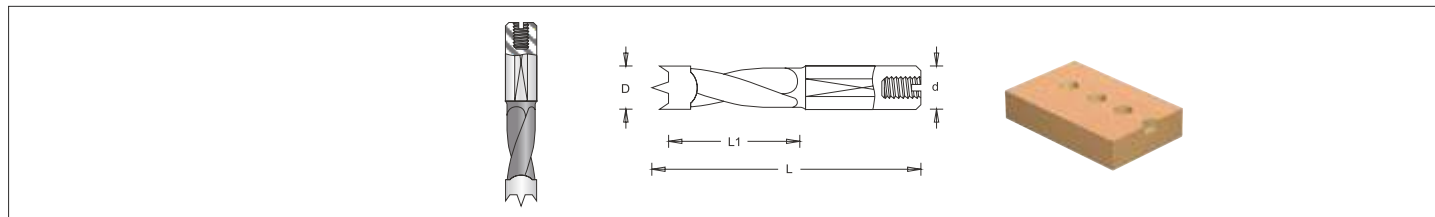

ŚREDNICA	PRAWA	LEWE	L	d	CENA
5	2010017	2010047	57.5	10x27	36.30
6	2010077	2010107	57.5	10x27	41.40
8	2010137	2010167	57.5	10x27	40.60
10	2010197	2010227	57.5	10x27	48.20

ŚREDNICA	PRAWA	LEWE	L	d	CENA
5	2010317	2010347	70.0	10x30	40.80
6	2010377	2010407	70.0	10x30	45.60
8	2010437	2010467	70.0	10x30	45.60
10	2010497	2010527	70.0	10x30	53.40

Wiertła przelotowe

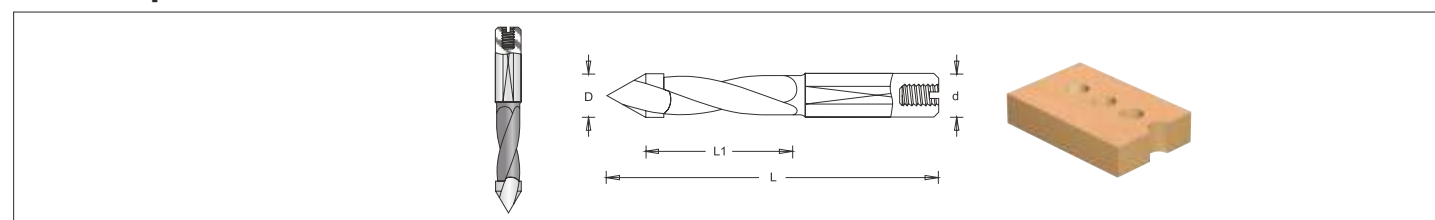

ŚREDNICA	PRAWA	LEWE	L	d	CENA
5	2016047	2016057	57.5	10x25	47.50
6	2016067	2016077	57.5	10x25	60.20
8	2016087	2016097	57.5	10x25	56.70
10	2016127	2016137	57.5	10x25	66.70

ŚREDNICA	PRAWA	LEWE	L	d	CENA
5	2016147	2016157	70.0	10x25	52.20
6	2016167	2016177	70.0	10x25	60.00
8	2016187	2016197	70.0	10x25	52.20
10	2016227	2016237	70.0	10x25	68.00

Wiertła puszkowe maszynowe

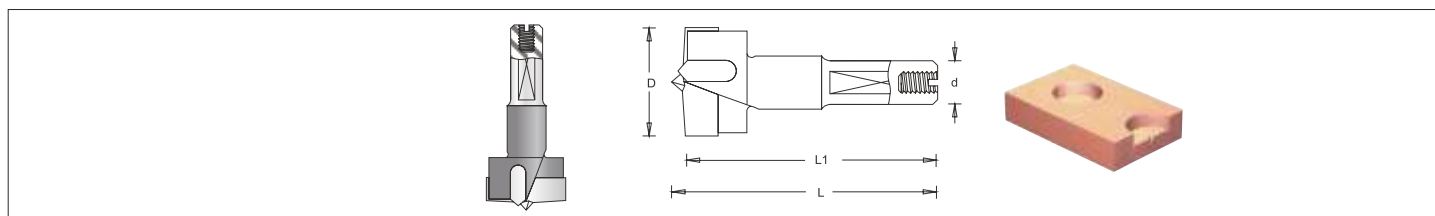

ŚREDNICA	PRAWA	LEWE	L	d	CENA
15	2031007	2031087	57.5	10x26	90.70
20	2031017	2031047	57.5	10x26	85.30
25	2031077	2031107	57.5	10x26	91.00
30	2031197	2031227	57.5	10x26	94.00
35	2031257	2031287	57.5	10x26	99.00

ŚREDNICA	PRAWA	LEWE	L	d	CENA
15	2031407	2031417	70.0	10x26	100.10
20	2031427	2031437	70.0	10x26	105.10
25	2031447	2031457	70.0	10x26	113.80
30	2031467	2031477	70.0	10x26	117.40
35	2031487	2031497	70.0	10x26	120.90

Wiertła puszkowe z chwytem walcowym

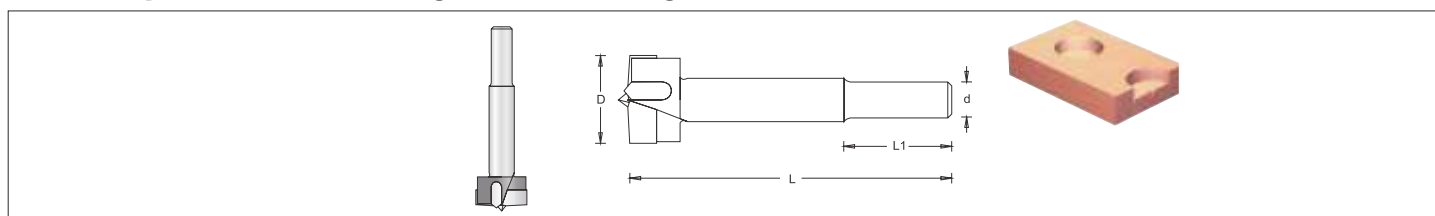

ŚREDNICA	SYMBOL	L1	L	d	CENA
10	2033107	30	90	10	93.90
15	2033157	30	90	10	81.80
17	2033177	30	90	10	112.10
18	2033187	30	90	10	107.00
25	2033257	30	90	10	101.10
30	2033307	30	90	10	97.50
35	2033357	30	90	10	106.00
40	2033407	30	90	10	130.90

Twój sprzedawca:

WIERTŁA PEŁNOWĘGLIKOWE

Wiertła nieprzelotowe Extended Life

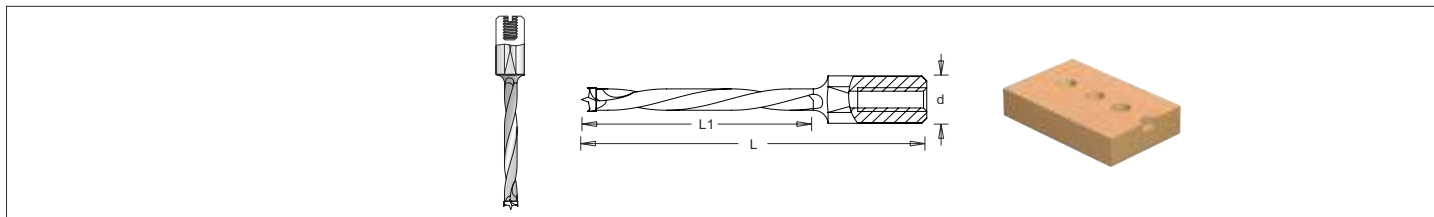

ŚREDNICA	PRAWA	LEWE	L	d	CENA
5	2064137	2064147	57.5	10x30	46.40
6	2064277	2064267	57.5	10x30	45.00
8	2064197	2064187	57.5	10x30	50.30
10	2064217	2064237	57.5	10x30	53.80

ŚREDNICA	PRAWA	LEWE	L	d	CENA
5	2064047	2064087	70.0	10x30	50.30
6	2064077	2064097	70.0	10x30	54.30
8	2064057	2064107	70.0	10x30	55.50
10	2064067	2064117	70.0	10x30	64.80

Wiertła Ditec

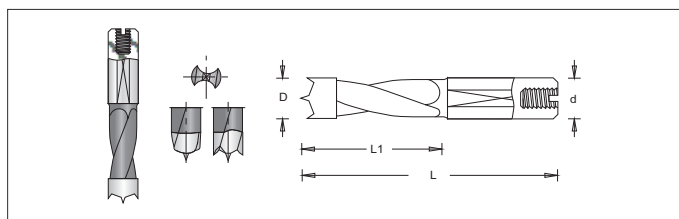

ŚREDNICA	PRAWA	LEWE	L	d	CENA
5	2017057	2017067	57.5	10x25	52.90
8	2017137	2017167	57.5	10x25	59.00
10	2017227	2017237	57.5	10x25	69.80

5	2017317	2017347	70.0	10x25	59.00
8	2017437	2017467	70.0	10x25	65.00
10	2017457	2017487	70.0	10x25	77.00

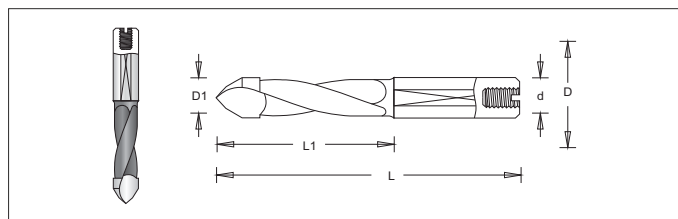

ŚREDNICA	PRAWA	LEWE	L	d	CENA
5	2017607	2017617	57.5	10x25	68.70
8	2017627	2017637	57.5	10x25	78.20
10	2017647	2017657	57.5	10x25	90.30

5	2017707	2017717	70.0	10x25	78.20
8	2017727	2017737	70.0	10x25	87.00
10	2017747	2017757	70.0	10x25	105.90

Wiertła nieprzelotowe pełnowęglikowe

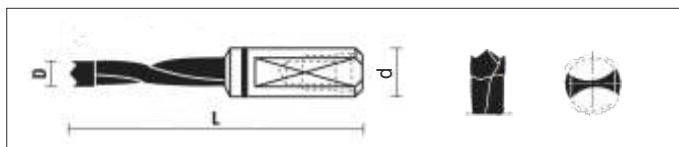

ŚREDNICA	PRAWA	LEWE	L	d	CENA
3	L116.030.R	L116.030.L	57.5	10x32	79.40
4	L116.040.R	L116.040.L	57.5	10x27	79.40
5	L116.050.R	L116.050.L	57.5	10x27	79.40
8	L116.080.R	L116.080.L	57.5	10x27	117.10

3	L117.030.R	L117.030.	70.0	10x38	80.30
4	L117.040.R	L117.040.L	70.0	10x30	75.90
5	L117.050.R	L117.050.L	70.0	10x30	75.90
6	L117.060.R	L117.060.L	70.0	10x30	88.40
7	L117.070.R	L117.070.L	70.0	10x30	115.20
8	L117.080.R	L117.080.L	70.0	10x30	101.40

Wiertła przelotowe pełnowęglikowe

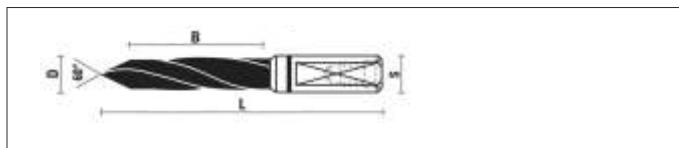

ŚREDNICA	PRAWA	LEWE	L	d	CENA
5	L129.050.R	L129.050.L	70.0	10x30	87.60
6	L129.060.R	L129.060.L	70.0	10x30	94.70
7	L135.070.R	L135.070.L	70.0	10x20	137.00
8	L129.080.R	L129.080.L	70.0	10x30	119.60

Wiertła "Twist" + Oprawki



ŚREDNICA	PRAWA	LEWE	B	L	CENA
2	L120.020.R	L120.020.L	18	49	33.10
2.5	L120.025.R	L120.025.L	22	55	39.90
3	L120.030.R	L120.030.L	22	55	40.60

ŚREDNICA		D	L	CENA
2	Z011.020.N	15	35	50.80
2.5	Z011.025.N	15	35	46.30
3	Z011.030.N	15	35	46.30

Wiertła puszkowe pełnowęglikowe



ŚREDNICA	PRAWA	LEWE	L	d	CENA
15	L155.150.R	L155.120.L	57	10x26	175.00
20	L155.200.R	L155.200.L	57	10x26	235.00
35	L155.350.R	L155.350.L	57	10x26	445.10
15	L156.150.R	L156.150.L	70	10x26	185.20
30	L156.300.R	L156.300.L	70	10x26	352.50
35	L156.350.R	L156.350.L	70	10x26	456.40